

Fig. 1

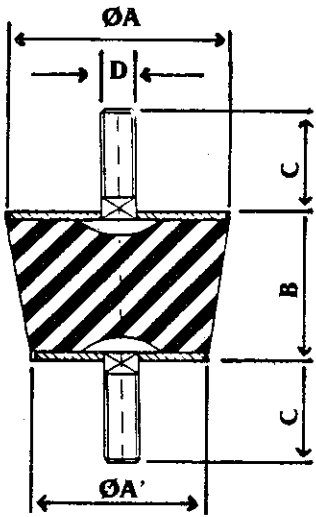

Fig. 2

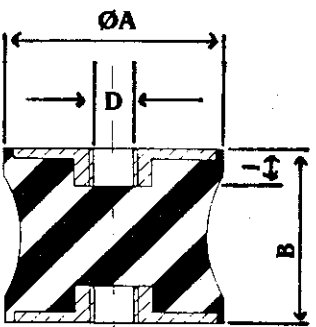

Fig. 3

RÉFÉRENCE REFERENCE	Fig	Dureté Hardness	DIMENSIONS (mm) DIMENSIONS (mm)				COMPRESSION COMPRESSION		CISAILLEMENT SHEAR	
			Ø A	B	D	C	Charge Load (Kg)	Flèche Deflection (mm)	Charge Load (Kg)	Flèche Deflection (mm)
T		Shöre								
3376	1	60	030	25	M-08	20	60	5,0±0,5	8,0	5,0±0,5
3230	1	60	060	36	M-10	30	250	7,0±1,0	40,0	7,0±1,0
3231	1	60	060	43	M-10	30	250	9,0±1,0	30,0	9,0±1,0
CT-60	1	60	060	25	M-10	30	300	5,0±0,5	40,0	5,0±0,5

RÉFÉRENCE REFERENCE	Fig	Dureté Hardness	DIMENSIONS (mm) DIMENSIONS (mm)					COMPRESSION COMPRESSION		CISAILLEMENT SHEAR	
			Ø A	Ø A'	B	D	C	Charge Load (Kg)	Flèche Deflection (mm)	Charge Load (Kg)	Flèche Deflection (mm)
A		Shöre									
A35B8x13	2	40	040	030	24	M-08	13	50	5,0±0,5	10,0	5,0±0,5
A35B8x23	2	40	040	030	24	M-08	23	50	5,0±0,5	10,0	5,0±0,5
A358x13	2	60	040	030	24	M-08	13	100	5,0±0,5	20,0	5,0±0,5
A358x23	2	60	040	030	24	M-08	23	100	5,0±0,5	20,0	5,0±0,5
A45B	2	40	050	040	34	M-08	23	100	7,0±1,0	20,0	7,0±1,0
A45	2	60	050	040	34	M-08	23	200	7,0±1,0	40,0	7,0±1,0

RÉFÉRENCE REFERENCE	Fig	Dureté Hardness	DIMENSIONS (mm) DIMENSIONS (mm)					COMPRESSION COMPRESSION		CISAILLEMENT SHEAR	
			Ø A	B	D	i	Charge Load (Kg)	Flèche Deflection (mm)	Charge Load (Kg)	Flèche Deflection (mm)	
H		Shöre									
3330	3	60	030	30	M-08	6	80	6,0±0,5	16,0	6,0±0,5	
3430	3	60	040	30	M-08	6	200	6,0±0,5	40,0	6,0±0,5	
3617	3	60	070	58	M-12	12	350	11,0±1,0	70,0	11,0±1,0	
3356	3	60	080	65	M-12	12	600	13,0±1,0	120,0	13,0±1,5	
3866	3	60	090	80	M-12	12	750	16,0±1,5	130,0	16,0±1,5	
3866RED	3	60	090	50	M-12	12	850	10,0±1,0	170,0	10,0±1,0	
3867	3	60	105	85	M-14	13	1.200	17,0±2,0	240,0	17,0±2,0	
HR102D60	3	60	102	55	M-16	15	1.000	11,0±1,5	200,0	11,0±1,5	
3868	3	60	130	95	M-16	15	1.800	19,0±2,0	320,0	19,0±2,0	

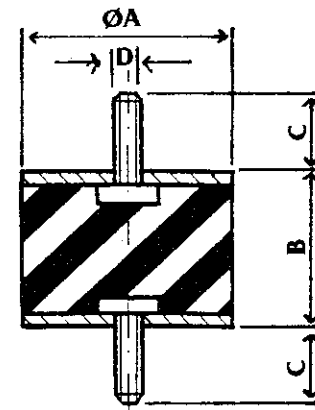

Fig. 1

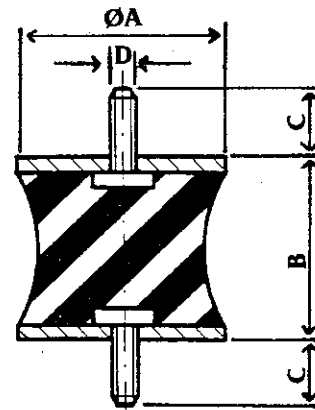

Fig. 2

RÉFÉRENCE REFERENCE	Fig	Dureté Hardness	DIMENSIONS (mm) DIMENSIONS (mm)				COMPRESSION COMPRESSION		CISAILLEMENT SHEAR	
			Ø A	B	D	C	Charge Load (Kg)	Flèche Deflection (mm)	Charge Load (Kg)	Flèche Deflection (mm)
SR		Shöre								
SR 000	1	50	012	15	M-05	10	15	3,0±0,5	1,5	2,0±0,5
SR 1610	1	50	016	10	M-05	12	20	2,0±0,5	2,0	2,0±0,5
SR 1615	1	50	016	15	M-05	12	15	3,0±0,5	2,0	3,0±0,5
SR 1620	1	50	016	20	M-05	12	15	4,0±0,5	2,0	4,0±0,5
SR 1625	1	50	016	25	M-05	12	15	5,0±0,5	2,0	5,0±0,5
SR 2008	1	50	020	08	M-06	18	45	1,0±0,3	4,5	1,5±0,3
SR 2015	1	50	020	15	M-06	18	35	3,0±0,5	3,5	3,0±0,5
SR 00-N	2	50	020	19	M-06	18	12	4,0±0,5	2,0	4,0±0,5
SR 2020	1	50	020	20	M-06	18	25	4,0±0,5	2,5	4,0±0,5
SR 2025	1	50	020	25	M-06	18	25	5,0±0,5	2,5	5,0±0,5
SR 2030	1	50	020	30	M-06	18	25	6,0±0,5	2,5	6,0±0,5
SR 2510	1	50	025	10	M-08	20	80	2,0±0,5	8,0	2,0±0,5
SR 2515	1	50	025	15	M-08	20	60	3,0±0,5	8,0	3,0±0,5
SR 2520	1	50	025	20	M-08	20	45	4,0±0,5	8,0	4,0±0,5
SR 2525	1	50	025	25	M-08	20	40	5,0±0,5	6,0	5,0±0,5
SR 2530	1	50	025	30	M-08	20	40	6,0±0,5	5,0	6,0±0,5
SR 2540	1	50	025	40	M-08	20	40	8,0±1,0	5,0	8,0±1,0
SR 3015	1	50	030	15	M-08	20	80	3,0±0,5	11,0	3,0±0,5
SR 00	1	50	028	22	M-08	20	60	5,0±0,5	11,0	5,0±0,5
SR 04	1	50	030	30	M-08	20	60	6,0±0,5	11,0	6,0±0,5
SR 3040	1	50	030	40	M-08	20	60	8,0±1,0	11,0	8,0±1,0
SR 4020	1	50	040	20	M-10	25	160	4,0±0,5	20,0	4,0±0,5
SR 0-N M8	2	50	040	28	M-08	30	40	5,5±0,5	7,0	5,5±1,0
SR 0-N	2	50	040	28	M-10	30	40	5,5±0,5	7,0	5,5±1,0
SR 0 M8	1	50	040	28	M-08	30	100	5,5±0,5	16,0	5,5±1,0
SR 0	1	50	040	28	M-10	30	100	5,5±0,5	16,0	5,5±1,0
SR 4035	1	50	040	35	M-10	25	100	7,0±1,0	16,0	7,0±1,0
SR 03	1	50	040	40	M-10	25	100	8,0±1,0	16,0	8,0±1,0
SR 4045	1	50	040	45	M-10	25	100	9,0±1,0	16,0	9,0±1,0
SR 02 red	1	50	050	25	M-10	30	175	5,0±0,5	25,0	5,0±0,5
SR 02	1	50	050	35	M-10	30	160	7,0±1,0	25,0	7,0±1,0
SR 01	1	50	050	45	M-10	30	150	9,0±1,0	25,0	9,0±1,0
SR 1-N	2	50	057	44	M-08	25	70	8,5±1,0	10,0	8,5±1,0
SR 2-N	2	50	057	44	M-08	25	130	8,5±1,0	25,0	8,5±1,0
SR 4 red	1	50	060	25	M-10	30	400	5,0±0,5	35,0	5,0±0,5
SR 4 med	1	50	060	35	M-10	30	300	7,0±1,0	35,0	7,0±1,0
SR 6045	1	50	060	45	M-10	30	250	9,0±1,0	35,0	9,0±1,0
SR 4-N	2	50	060	60	M-10	30	150	10,0±1,0	20,0	12,0±1,0
SR 4	1	50	060	60	M-10	30	225	12,0±1,0	35,0	12,0±1,0
SR 73	1	50	070	35	M-12	35	450	7,0±1,0	55,0	7,0±1,0
SR 45	1	50	070	50	M-12	35	300	10,0±1,0	35,0	10,0±1,0
SR 5 red	1	50	080	30	M-14	45	950	6,0±1,0	100,0	6,0±1,0
SR 85	1	50	080	40	M-14	45	600	8,0±1,0	80,0	8,0±1,0
SR 5-N	2	50	080	70	M-14	45	350	14,0±1,5	65,0	14,0±1,5
SR 6 red	1	50	095	40	M-16	45	1.000	8,0±1,0	140,0	8,0±1,0
SR 6-N	2	50	095	76	M-16	45	450	15,0±1,5	75,0	15,0±1,5
SR 7-N	2	50	108	75	M-16	45	600	15,0±1,5	140,0	15,0±1,5
SR 8-N	2	50	130	85	M-16	45	900	17,0±2,0	185,0	17,0±2,0
SR 10	1	50	150	75	M-20	50	1.800	15,0±1,5	275,0	15,0±1,5

Accessoires silentblocs



Accessoires silentblocs

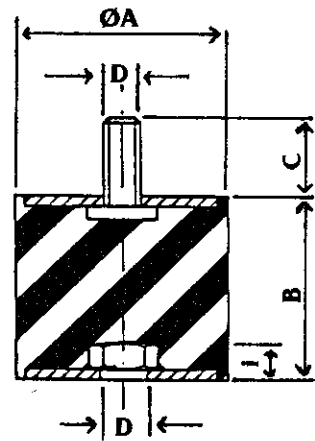

Fig. 1

B3022
 Ø30 B:25
 M08

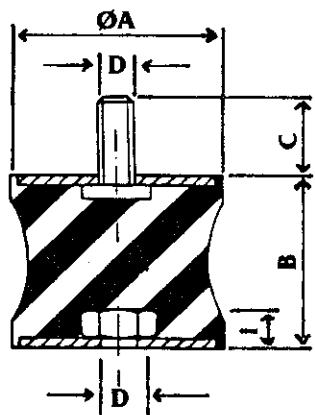

Fig. 2

RÉFÉRENCE REFERENCE	Fig	Dureté Hardness	DIMENSIONS (mm)					COMPRESSION COMPRESSION		CISAILLEMENT SHEAR	
			Ø A	B	D	C	i	Charge Load (Kg)	Flèche Deflection (mm)	Charge Load (Kg)	Flèche Deflection (mm)
MR		Shöre									
MR 1610	1	50	016	10	M-05	12	5	20	1,5±0,5	2,0	2,0±0,5
MR 1615	1	50	016	15	M-05	12	5	15	3,0±0,5	2,0	3,0±0,5
MR 1620	1	50	016	20	M-05	12	5	15	4,0±0,5	2,0	4,0±0,5
MR 1625	1	50	016	25	M-05	12	5	15	5,0±0,5	2,0	5,0±0,5
MR 2015	1	50	020	15	M-06	18	5	35	3,0±0,5	3,5	3,0±0,5
MR 2020	1	50	020	20	M-06	18	5	30	4,0±0,5	2,5	4,0±0,5
MR 2025	1	50	020	25	M-06	18	5	25	5,0±0,5	2,5	5,0±0,5
MR 2030	1	50	020	30	M-06	18	5	25	6,0±0,5	2,5	6,0±0,5
MR 2520	1	50	025	20	M-08	20	6	50	4,0±0,5	8,0	4,0±0,5
MR 2525	1	50	025	25	M-08	20	6	45	5,0±0,5	6,0	5,0±0,5
MR 2530	1	50	025	30	M-08	20	6	40	6,0±0,5	5,0	6,0±0,5
MR 2540	1	50	025	40	M-08	20	6	40	8,0±1,0	5,0	8,0±1,0
MR 3015	1	50	030	15	M-08	20	6	90	3,0±0,5	11,0	3,0±0,5
MR 00	1	50	028	22	M-08	20	6	60	5,0±0,5	11,0	5,0±0,5
MR 3030	1	50	030	30	M-08	20	6	60	6,0±0,5	11,0	6,0±0,5
MR 3040	1	50	030	40	M-08	20	6	60	8,0±1,0	11,0	8,0±1,0
MR 4020	1	50	040	20	M-10	25	9	175	4,0±0,5	20,0	4,0±0,5
MR 0-N M8	2	50	040	28	M-08	30	8	40	5,5±0,5	7,0	5,5±1,0
MR 0-N	2	50	040	28	M-10	30	9	40	5,5±0,5	7,0	5,5±1,0
MR 0 M8	1	50	040	28	M-08	30	8	125	5,5±0,5	16,0	5,5±1,0
MR 0	1	50	040	28	M-10	30	9	125	5,5±0,5	16,0	5,5±1,0
MR 4035	1	50	040	35	M-10	25	9	100	7,0±1,0	16,0	7,0±1,0
MR 4040	1	50	040	40	M-10	25	9	100	8,0±1,0	16,0	8,0±1,0
MR 4045	1	50	040	45	M-10	25	9	100	9,0±1,0	16,0	9,0±1,0
MR 02 red	1	50	050	25	M-10	30	9	175	5,0±0,5	25,0	5,0±0,5
MR 02	1	50	050	35	M-10	30	9	160	7,0±1,0	25,0	7,0±1,0
MR 01	1	50	050	45	M-10	30	9	150	9,0±1,0	25,0	9,0±1,0
MR 2-N	2	50	057	44	M-08	25	8	130	8,5±1,0	25,0	8,5±1,0
MR 4 red	1	50	060	25	M-10	30	9	400	5,0±0,5	35,0	5,0±0,5
MR 4 med	1	50	060	35	M-10	30	9	300	7,0±1,0	35,0	7,0±1,0
MR 6045	1	50	060	45	M-10	30	9	250	9,0±1,0	35,0	9,0±1,0
MR 4-N	2	50	060	60	M-10	30	9	150	10,0±1,0	20,0	10,0±1,0
MR 4	1	50	060	60	M-10	30	9	225	12,0±1,0	35,0	12,0±1,0
MR 73	1	50	070	35	M-12	35	12	450	7,0±1,0	55,0	7,0±1,0
MR 45	1	50	070	50	M-12	35	12	300	10,0±1,0	35,0	10,0±1,0
MR 5 red	1	50	080	30	M-14	45	13	950	6,0±1,0	100,0	6,0±1,0
MR 85	1	50	080	40	M-14	45	13	600	8,0±1,0	80,0	8,0±1,0
MR 5-N	2	50	080	70	M-14	45	13	350	14,0±1,5	65,0	14,0±1,5
MR 6 red	1	50	095	40	M-16	45	15	1.000	8,0±1,0	140,0	8,0±1,0
MR 6-N	2	50	095	76	M-16	45	15	450	15,0±1,5	75,0	15,0±1,5
MR 7-N	2	50	108	75	M-16	45	15	600	15,0±1,5	140,0	15,0±1,5
MR 8-N	2	50	130	85	M-16	45	15	900	17,0±2,0	185,0	17,0±2,0
MR 10	1	50	150	75	M-20	50	20	1.800	15,0±1,5	275,0	15,0±1,5

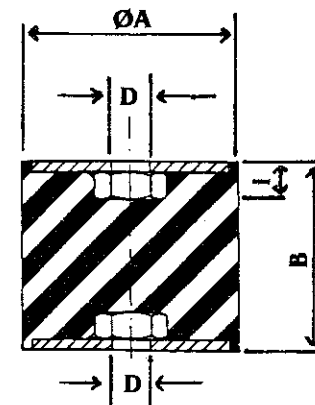

Fig. 1

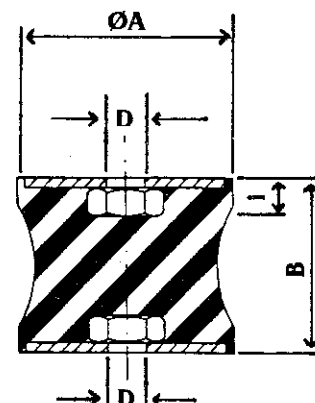

Fig. 2

RÉFÉRENCE REFERENCE	Fig	Dureté Hardness	DIMENSIONS (mm)				COMPRESSION COMPRESSION		CISAILLEMENT SHEAR	
			Ø A	B	D	i	Charge Load (Kg)	Flèche Deflection (mm)	Charge Load (Kg)	Flèche Deflection (mm)
HR		Shöre								
HR 1615	1	50	016	15	M-05	5	15	3,0±0,5	2,0	2,0±0,5
HR 1620	1	50	016	20	M-05	5	15	4,0±0,5	2,0	4,0±0,5
HR 1625	1	50	016	25	M-05	5	15	5,0±0,5	2,0	5,0±0,5
HR 2015	1	50	020	15	M-06	5	35	2,0±0,5	3,5	3,0±0,5
HR 2020	1	50	020	20	M-06	5	30	4,0±0,5	2,5	4,0±0,5
HR 2025	1	50	020	25	M-06	5	30	5,0±0,5	2,5	5,0±0,5
HR 2030	1	50	020	30	M-06	5	25	6,0±0,5	2,5	6,0±0,5
HR 2520	1	50	025	20	M-08	6	50	4,0±0,5	8,0	4,0±0,5
HR 2525	1	50	025	25	M-08	6	45	5,0±0,5	6,0	5,0±0,5
HR 2530	1	50	025	30	M-08	6	40	6,0±0,5	5,0	6,0±0,5
HR 2540	1	50	025	40	M-08	6	40	8,0±1,0	5,0	8,0±1,0
HR 00	1	50	028	22	M-08	6	60	4,5±0,5	11,0	5,0±0,5
HR 3030	1	50	030	30	M-08	6	60	6,0±0,5	11,0	6,5±0,5
HR 3040	1	50	030	40	M-08	6	60	8,0±1,0	11,0	8,0±1,0
HR 4020	1	50	040	20	M-10	9	175	4,0±0,5	20,0	4,0±0,5
HR 0-N M8	2	50	040	28	M-08	8	40	5,5±0,5	7,0	5,5±1,0
HR 0-N	2	50	040	28	M-10	9	40	5,5±0,5	7,0	5,5±1,0
HR 0 M8	1	50	040	28	M-08	8	125	5,5±0,5	16,0	5,5±1,0
HR 0	1	50	040	28	M-10	9	125	5,5±0,5	16,0	5,5±1,0
HR 4035	1	50	040	35	M-10	9	100	7,0±1,0	16,0	7,0±1,0
HR 4040	1	50	040	40	M-10	9	100	8,0±1,0	16,0	8,0±1,0
HR 4045	1	50	040	45	M-10	9	100	9,0±1,0	16,0	9,0±1,0
HR 02 red	1	50	050	25	M-10	9	175	5,0±0,5	25,0	5,0±0,5
HR 02	1	50	050	35	M-10	9	160	7,0±1,0	25,0	7,0±1,0
HR 01	1	50	050	45	M-10	9	150	9,0±1,0	25,0	9,0±1,0
HR 2-N	2	50	057	44	M-08	8	130	8,5±1,0	25,0	8,5±1,0
HR 4 red	1	50	060	25	M-10	9	400	5,0±0,5	35,0	5,0±0,5
HR 4 med	1	50	060	35	M-10	9	300	7,0±1,0	35,0	7,0±1,0
HR 6045	1	50	060	45	M-10	9	250	9,0±1,0	35,0	9,0±1,0
HR 4-N	2	50	060	60	M-10	9	150	10,0±1,0	20,0	12,0±1,0
HR 4	1	50	060	60	M-10	9	225	12,0±1,0	35,0	11,0±1,0
HR 73	1	50	070	35	M-12	12	450	7,0±1,0	55,0	7,0±1,0
HR 45	1	50	070	50	M-12	12	300	10,0±1,0	35,0	10,0±1,0
HR 5 red	1	50	080	30	M-14	13	950	6,0±1,0	100,0	6,0±1,0
HR 85	1	50	080	40	M-14	13	600	8,0±1,0	80,0	8,0±1,0
HR 5-N	2	50	080	70	M-14	13	350	14,0±1,5	65,0	14,0±1,5
HR 6 red	1	50	095	40	M-16	15	1.000	8,0±1,0	140,0	8,0±1,0
HR 6-N	2	50	095	76	M-16	15	450	15,0±1,5	75,0	15,0±1,0
HR 102D45	1	45	102	55	M-16	15	500	11,0±1,5	100,0	11,0±1,5
HR 102D60	1	60	102	55	M-16	15	1.000	11,0±1,5	200,0	11,0±1,5
HR 102D75	1	75	102	55	M-16	15	2.500	11,0±1,5	350,0	11,0±1,5
HR 7-N	2	50	108	75	M-16	15	600	15,0±1,5	140,0	15,0±1,5
HR 8-N	2	50	130	85	M-16	15	900	17,0±2,0	185,0	17,0±2,0
HR 10	1	50	150	75	M-20	20	1.800	15,0±0,5	275,0	15,0±1,5

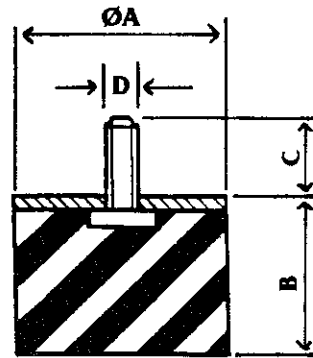

Fig. 1

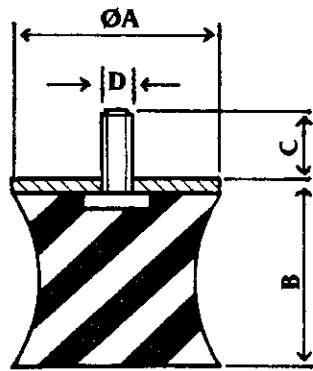

Fig. 2

RÉFÉRENCE REFERENCE	Fig	Dureté Hardness	DIMENSIONS (mm) DIMENSIONS (mm)				COMPRESSION COMPRESSION	
			Ø A	B	D	C	Charge Load (Kg)	Flèche Deflection (mm)
R		Shöre						
R 000	1	50	012	15	M-05	10	15	3,0±0,5
R 1610	1	50	016	10	M-05	12	20	2,0±0,5
R 1615	1	50	016	15	M-05	12	15	3,0±0,5
R 1620	1	50	016	20	M-05	12	15	4,0±0,5
R 1625	1	50	016	25	M-05	12	15	5,0±0,5
R 2008	1	50	020	08	M-06	18	45	1,6±0,5
R 2015	1	50	020	15	M-06	18	35	3,0±0,5
R 2020	1	50	020	20	M-06	18	25	4,0±0,5
R 2025	1	50	020	25	M-06	18	25	5,0±0,5
R 2030	1	50	020	30	M-06	18	25	6,0±0,5
R 2510	1	50	025	10	M-08	20	50	2,0±0,5
R 2515	1	50	025	15	M-08	20	40	3,0±0,5
R 2520	1	50	025	20	M-08	20	40	4,0±0,5
R 2525	1	50	025	25	M-08	20	40	5,0±0,5
R 2530	1	50	025	30	M-08	20	40	6,0±0,5
R 2540	1	50	025	40	M-08	20	40	8,0±1,0
R 3015	1	50	030	15	M-08	20	80	3,0±0,5
R 00	1	50	028	22	M-08	20	60	5,0±0,5
R 3030	1	50	030	30	M-08	20	60	6,0±0,5
R 3040	1	50	030	40	M-08	20	60	8,0±1,0
R 4020	1	50	040	20	M-10	25	140	4,0±0,5
R 0	1	50	040	28	M-10	30	100	5,5±0,5
R 4035	1	50	040	35	M-10	25	100	7,0±1,0
R 4040	1	50	040	40	M-10	25	100	8,0±1,0
R 4045	1	50	040	45	M-10	25	90	9,0±1,0
R 02 red	1	50	050	25	M-10	30	175	5,0±0,5
R 02	1	50	050	35	M-10	30	160	7,0±1,0
R 01	1	50	050	45	M-10	30	150	9,0±1,0
R 4 red	1	50	060	25	M-10	30	400	5,0±0,5
R 4 med	1	50	060	35	M-10	30	300	7,0±1,0
R 6045	1	50	060	45	M-10	30	250	9,0±1,0
R 4-N	2	50	060	60	M-10	30	150	10,0±1,0
R 4	1	50	060	60	M-10	30	225	12,0±1,0
R 73	1	50	070	35	M-12	35	450	7,0±1,0
R 45	1	50	070	50	M-12	35	300	10,0±1,0
R 5 red	1	50	080	30	M-14	45	950	6,0±1,0
R 85	1	50	080	40	M-14	45	600	8,0±1,0
R 5-N	2	50	080	70	M-14	45	350	14,0±1,5
R 6-N	2	50	095	76	M-16	45	450	15,0±1,5

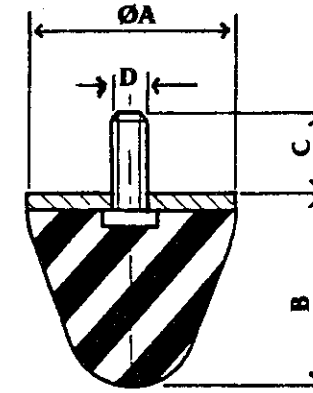

Fig. 1

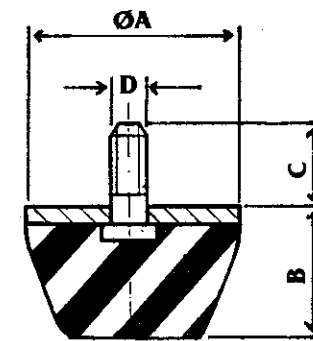

Fig. 2

RÉFÉRENCE REFERENCE	Fig	Dureté Hardness	DIMENSIONS (mm) DIMENSIONS (mm)				COMPRESSION COMPRESSION		CHOC SHOCK	
			Ø A	B	D	C	Charge Load (Kg)	Flèche Deflection (mm)	Charge Load (Kg)	Flèche Deflection (mm)
TP		Shöre								
TP25	1	60	025	20	M-08	20	40	4,0±0,5	100	8,0±2,0
TP30	1	60	030	30	M-06	15	50	6,0±1,0	140	12,0±2,0
TP50	1	60	050	65	M-08	30	90	13,0±1,5	370	26,0±3,0
TP70	1	60	070	60	M-12	35	160	12,0±1,5	550	24,0±3,0
TP85	2	60	084	53	M-12	35	375	11,0±1,5	1.250	21,0±2,5
TP95	1	60	095	80	M-16	45	350	16,0±2,0	1.100	32,0±3,5
TP96	2	60	095	47	M-16	45	675	9,0±1,0	1.600	19,0±2,0
TP120	2	60	120	75	M-16	50	2.000	15,0±2,0	4.500	30,0±3,5
TP220	2	60	220	136	M-24	80	3.800	27,0±3,0	10.000	54,0±6,0